

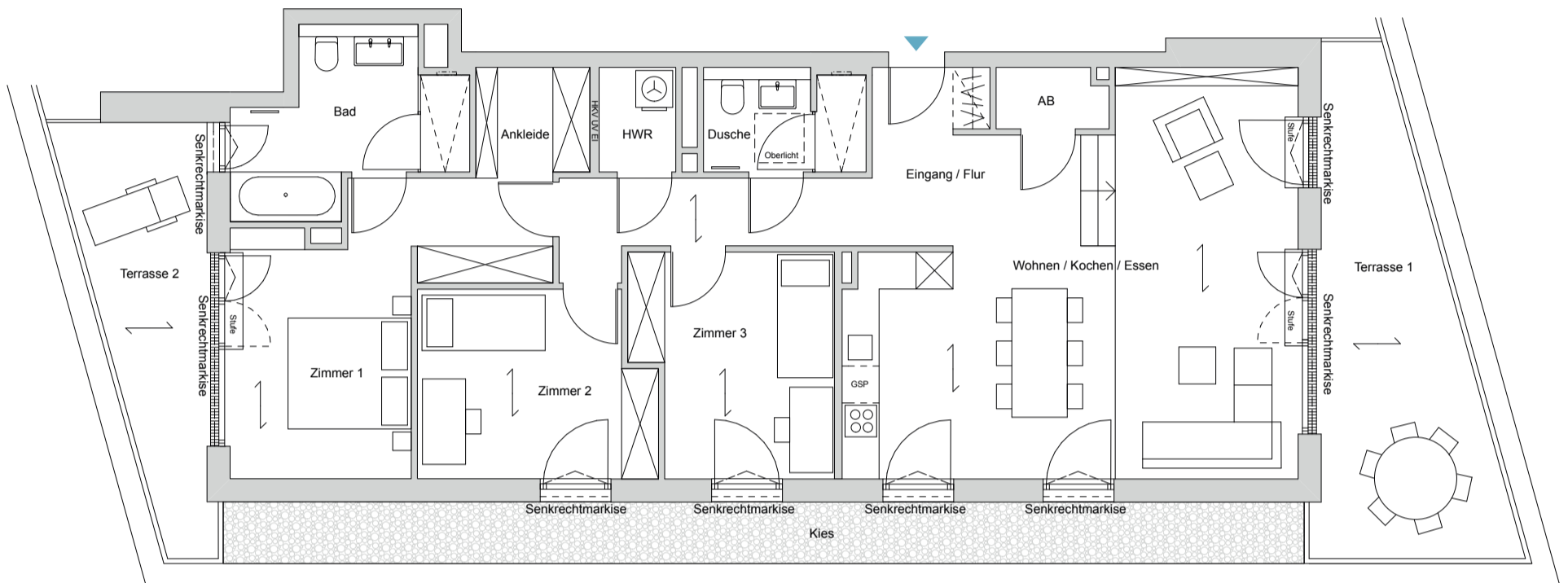



Haus 3, 4. OG, WE 62 (3.4.1), 4 Zimmer, 126,71 m<sup>2</sup>



Eingang / Flur	10,60 m <sup>2</sup>
Wohnen / Kochen / Essen	41,41 m <sup>2</sup>
Zimmer 1 (inkl. Ankleide)	19,93 m <sup>2</sup>
Zimmer 2	11,30 m <sup>2</sup>
Zimmer 3	11,23 m <sup>2</sup>
Bad	8,60 m <sup>2</sup>
Dusche	4,31 m <sup>2</sup>
HWR	2,12 m <sup>2</sup>
AB	1,74 m <sup>2</sup>
Terrasse 1 (50%)	9,14 m <sup>2</sup>
Terrasse 2 (50%)	6,33 m <sup>2</sup>
<b>Gesamt</b>	<b>126,71 m<sup>2</sup></b>

- Legende:
-  abgehängte Decke
  -  Dreh-/Kippfenster
  -  Verlegerichtung Parkett

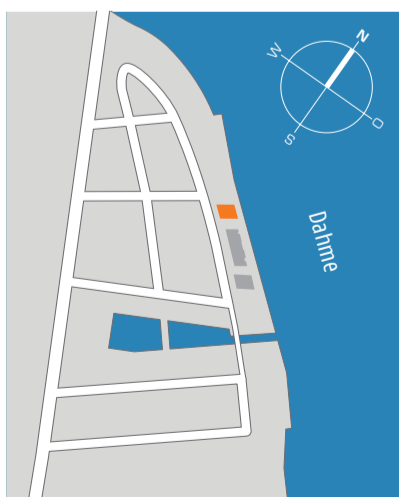

Lage im Quartier

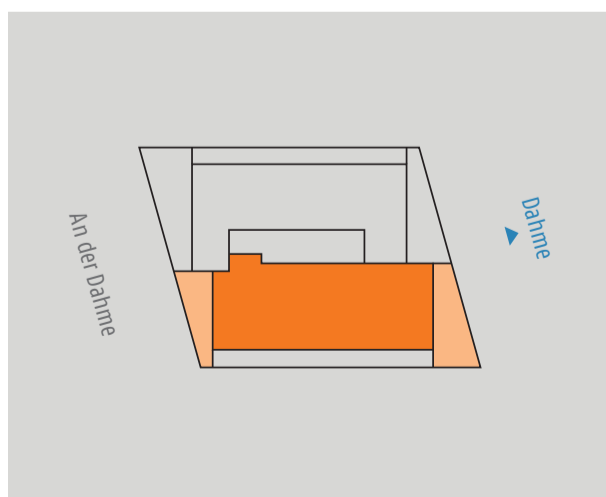

Lage im Objekt



Ansicht Nord-Ost

